

SECTIS DESIGN

Where Art and Design Meet™

Sectis Grille Data Sheet.

Description.

Standard Sectis grille panels are made of members 3" deep by .75" wide and have a 2.64" space between them. Custom widths and spacing available. The panels are 2x8' with its members traveling on the 8' section.

Attachment.

Ceiling.

They are attached fastening directly through the backer into the heavy-duty main T-bars from a standard T bar grid. The main T should be perpendicular to the members. Plywood backers are 2' center to center to align with main T bars.

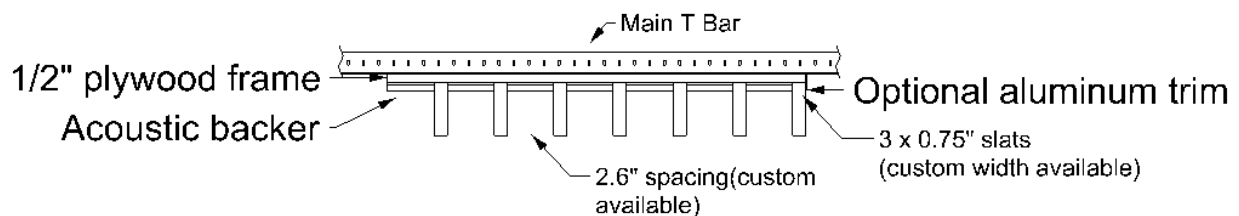
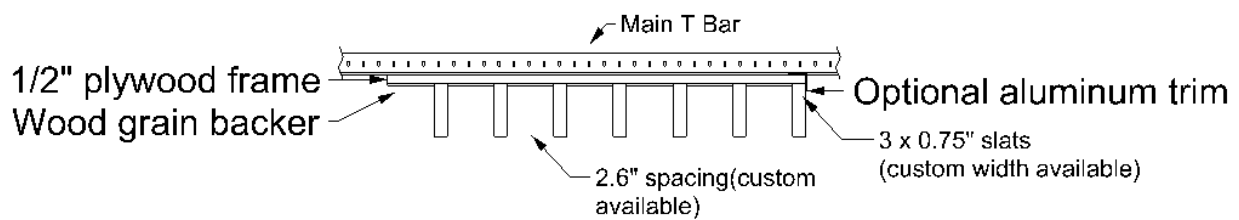
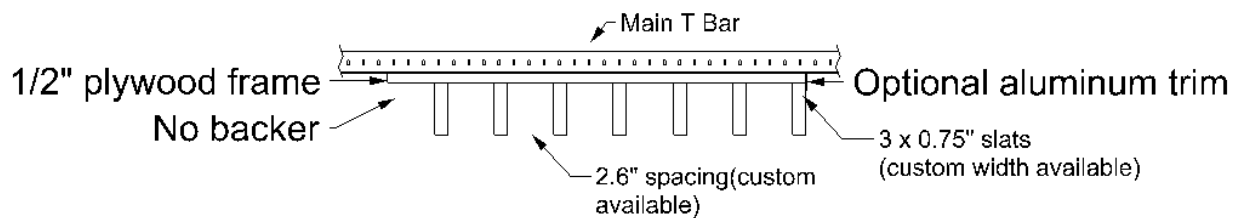

SECTIS DESIGN

Where Art and Design Meet™

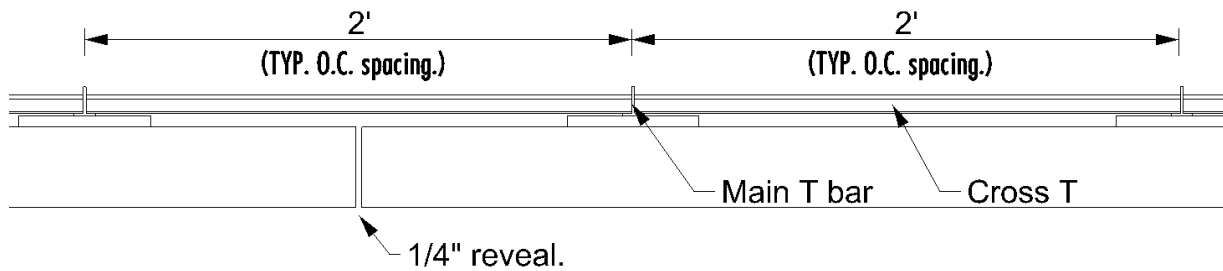

Wall.

Direct attachment.

Slats are individually installed to the wall using provided clips and screws. Screws are placed using the included template for precise location.

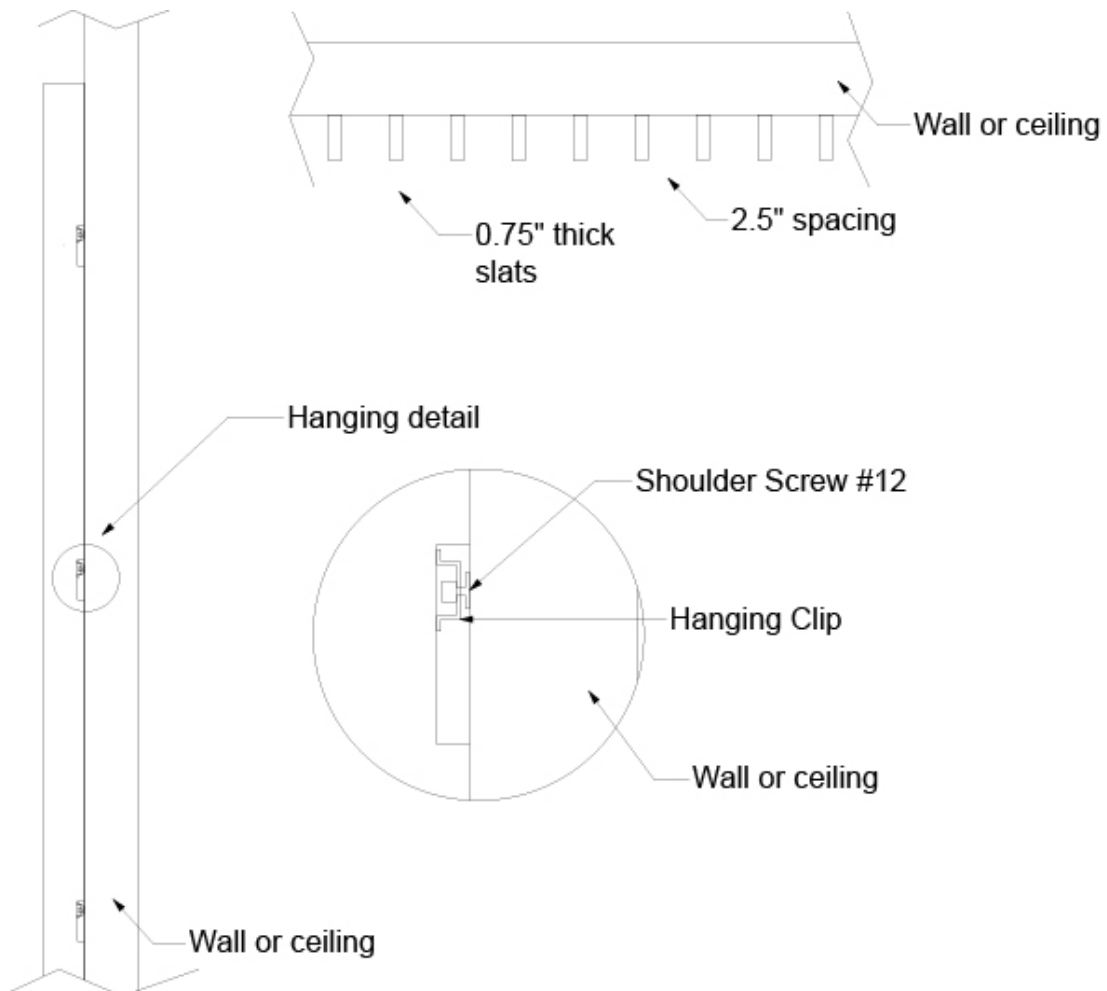

SECTIS DESIGN

Where Art and Design Meet™

Crossbar attachment with backer.

They are attached fastening directly through the backer into the wall. There are two strips of backer that will cover the screws after the installation.

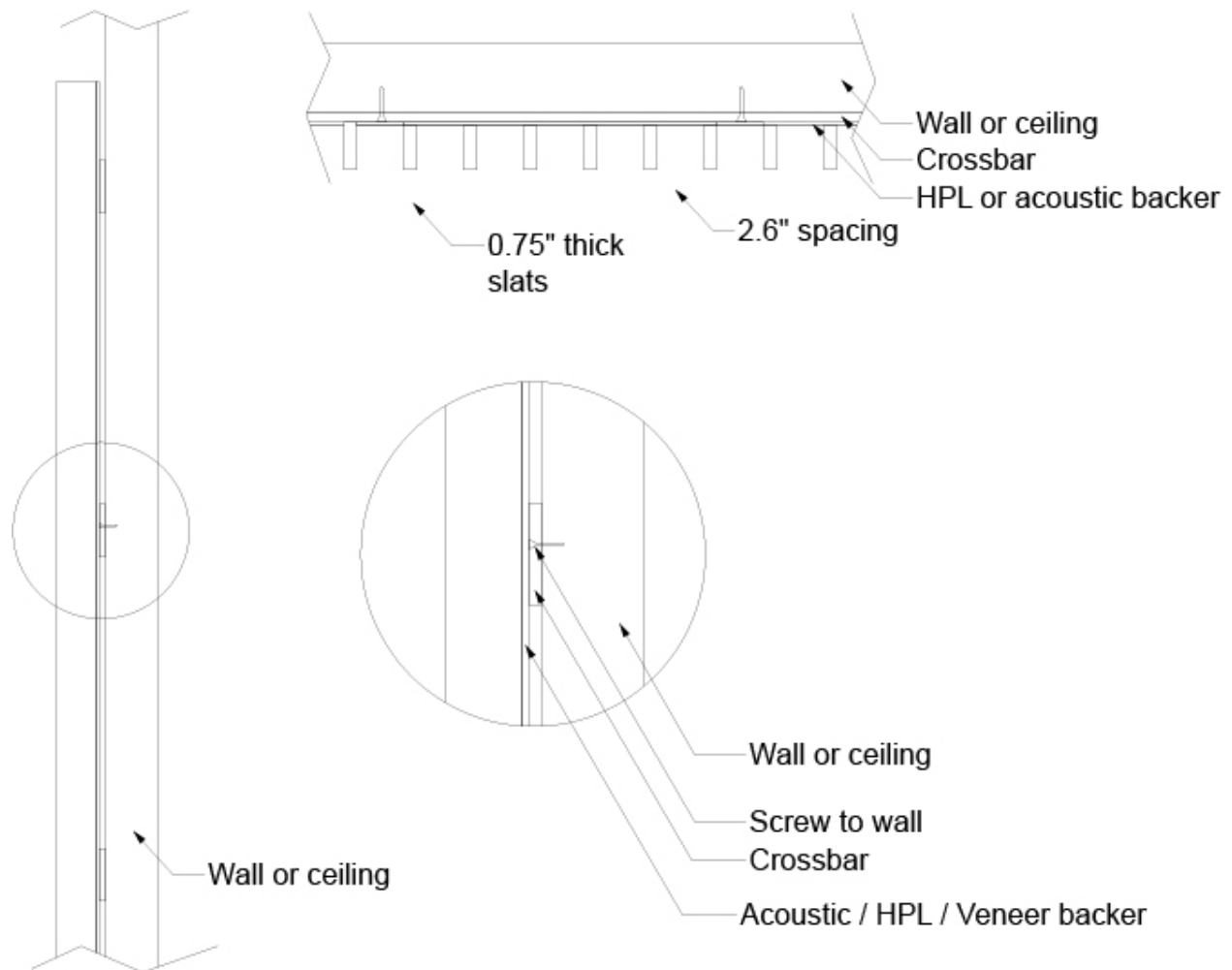

Materials.

Members are made of FSC MDF with HPL laminate and matching edge band for fire retardant requirements. FSC particle board with melamine for non-fire retardant needs.

Finishes.

SECTIS DESIGN

Where Art and Design Meet™

There are 35 colors available for the main members, and 12 colors for the acoustic backers. When open to above, plywood backer can be black or white.

Acclimatization.

To acclimate MDF to its intended indoor environment, it is recommended to store the MDF in the room where it will be installed for at least 48 hours before installation. This allows the MDF to adjust to the temperature and humidity of the room. It is also important to ensure that the MDF is stored in a dry area and is not exposed to moisture or direct sunlight, as this can affect the moisture content of the MDF and impact its performance.

Seismic.

Sectis Linear achieves seismic code compliance through its mechanical direct screw attachment to the T-Bar grid using the cross-piece backer. It is important to consult local codes or a licensed engineer for any supplementary requirements.

Acoustics.

Sectis Linear can enhance acoustic using our backers to be installed between the members.

Suspension.

Sectis Linear is attached directly to 15/16" heavy-duty T-Bar main runners that are installed at 2-foot intervals.

Weight.

Sectis Linear weights around 4.5lb SQF. Custom members or backers might increase the weight.

Fire Rating.

Main members and components can be coated with Class I (A) Fire Retardant chemicals.